

TOSHIBA

B-852

WIDE WEB PRINTER

Product brochure

- > With powerful networking capabilities, the B-852 wide web printer from TOSHIBA delivers outstanding performance for a wide variety of environments and applications.
- > This innovative industrial printer offers superior features including extremely fast processing, large internal memory, web printer controls and outstanding SNMP networking tools*.



*Also links to other TOSHIBA products including the e-studio series, an evolutionary family of information devices that fit perfectly within commercial information environments.

**TOGETHER
INFORMATION**

APPLICATIONS

Powerful wide web printing

The TOSHIBA B-852 printer with exceptional performance and the ultimate in networking tools.

- > Manufacturing
- > Automotive
- > Heavy Industry
- > Steel Industry
- > Paper Industry
- > Forestry
- > Chemical Industry
- > Pharmaceutical Industry
- > Textile Industry
- > Retail Distribution
- > Transport and Logistics

BRINGING IT ALL TOGETHER

Speed and Functionality

Utilising ground-breaking CPU technology from TOSHIBA, the B-852 offers high-speed printing and enhanced processing via an extensive choice of interfaces – including USB 2.0 and internal LAN. The options of serial and wireless LAN interfaces provide additional flexibility and choice, making the B-852 adaptable to the widest variety of environments and applications.

High Print Quality

The B-852 300 dpi, 216 mm wide printhead facilitates rapid printing of large format compliance labels.

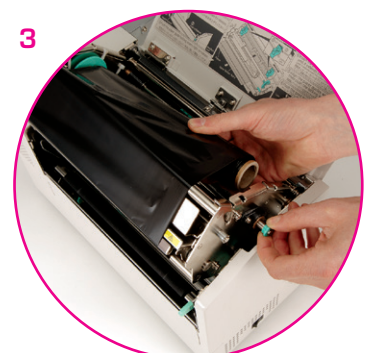
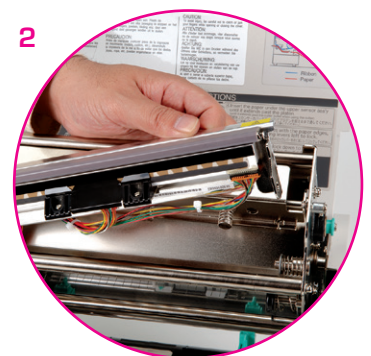

SPECIFICATIONS

Future Proofing

For future proofing, the B-852 printer is compatible with legacy systems, TOSHIBA or non-TOSHIBA. With the powerful Basic Command Interpreter (BCI) program, incoming data can be manipulated to generate the correct label formats. The BCI can also communicate with external devices allowing the easy integration of other technology systems.

Fully Compatible

Software and supplies are compatible with TOSHIBA's previous B-852 printer model. Existing media stock and grades do not need to be changed.

SNMP Tools

The B-852 comes with a free Network Management Suite that allows the user to:

- Manage all the TOSHIBA printers attached to the network through their IP address.
- Display system information and firmware versions, allowing firmware to be updated across the network simultaneously.
- View the status of each individual printer connected to the network in real time with real-time alerts (including viewing web pages).
- View a graphical display of the alerted error with the instructions necessary to resolve it, even emailing the service call centre number when needed.

Lower Cost of Ownership

All TOSHIBA products are manufactured at TOSHIBA's own facilities, providing the assurance of complete reliability and quality of key components essential for low overall cost of ownership. To lower the cost of ownership further the B-852 has large internal memory as standard with no requirement for costly PCMCIA boards or ATA memory cards.

Rugged and Robust

A field-proven heavy duty steel cabinet and sturdy inner mechanism combine to offer the B-852 the same robustness and reliability as the TOSHIBA SX series of industrial printers.



General

Printhead	Flat type
Dimensions	385 (W) x 181 (D) x 243 (H) mm 385 (W) x 427 (D) x 243 (H) mm with supply holder installed
Weight	15.6 kg (without media and ribbon)
Interfaces	Bidirectional parallel port, USB 2.0, LAN (100BASE), serial port*, wireless LAN*

Print

Method	Thermal transfer / Direct thermal
Print Width	Maximum 216.8 mm
Print Length	Maximum 640 mm
Print Speed	Up to 101.6 mm/s
Resolution	11.8 dots/mm (300 dpi)
Barcodes	UPC/EAN/JAN, Code 39, Code 93, Code 128, EAN 128, NW7, MSI, Industrial 2 of 5, ITF, Postnet, RM4SCC, KIX-code, RSS14, Customer Bar Code
2D Code	Data Matrix, PDF 417, Maxicode, QR code, Micro PDF 417, CP Code
Fonts	Bitmap font (21 fonts), Outline font (4 types), Price font (3 types)

Options

Cutter module, wireless LAN module, serial interface board, expansion I/O board, RTC (real time clock)

* Optional

> Thermal Transfer Ribbons

Toshiba approved thermal transfer ribbons are relied on every day by businesses worldwide, whether it's for mass-produced short-term label printing or for highly specialised identification techniques using advanced resin products.



BarTender
Label Printing Software

> A One-Stop Solution

Toshiba offers a total solution including a full range of approved media, labels, ribbons and cleaning products. A European support network in the majority of European countries provides essential peace of mind that - once installed - the printers will be serviced and maintained by experienced engineers and service staff.

> Together Information

Toshiba is breaking down barriers by transforming the way we manage, display and share information. Drawing on an integrated portfolio of world-class printing and scanning technology, we create tailored, eco-friendly solutions that enable organisations to maximise the value of the data and ideas that underpin them.

At Toshiba, we believe the most successful businesses are those that communicate information in the most effective way. We call this Together Information.

Find out what Together Information could mean for you at http://www.toshibatec-ris.com/ris_tecfiles/ads/logistics/index.html

> Options

The B-852 printer can be extended with various modules:

- Cutter module: A swing cutter to physically separate labels or continuous media automatically after printing.
- Expansion I/O interface board: Allows connection to external automated systems such as applicators or on-line verifiers.
- Real-time clock

> Customer Benefits

The B-852 wide web printer has been designed to benefit the end user with:

- New and improved connectivity features
- Increased expandability options
- Higher processing speed to improve data processing of large files
- Easy maintenance and low cost of ownership
- Capability to replace legacy systems and competitors' products.

TOSHIBA TEC UK IMAGING SYSTEMS LTD

Abbey Cloisters, Abbey Green, Chertsey, Surrey KT16 8RB

Telephone

+44 (0)843 2244944

Fax

+44 (0)843 3512024

Website

www.toshibatec.co.uk



Your Toshiba Dealer:

